

Kozijnverankering

Bouwdetail gebaseerd op: Rc vloer $\geq 5,0 \text{ m}^2\text{-K/W}$ U-deur $\leq 1,65 \text{ W/m}^2\text{-K}$ qv10-waarde $\leq 0,4 \text{ dm}^3/\text{s}$ per m^2

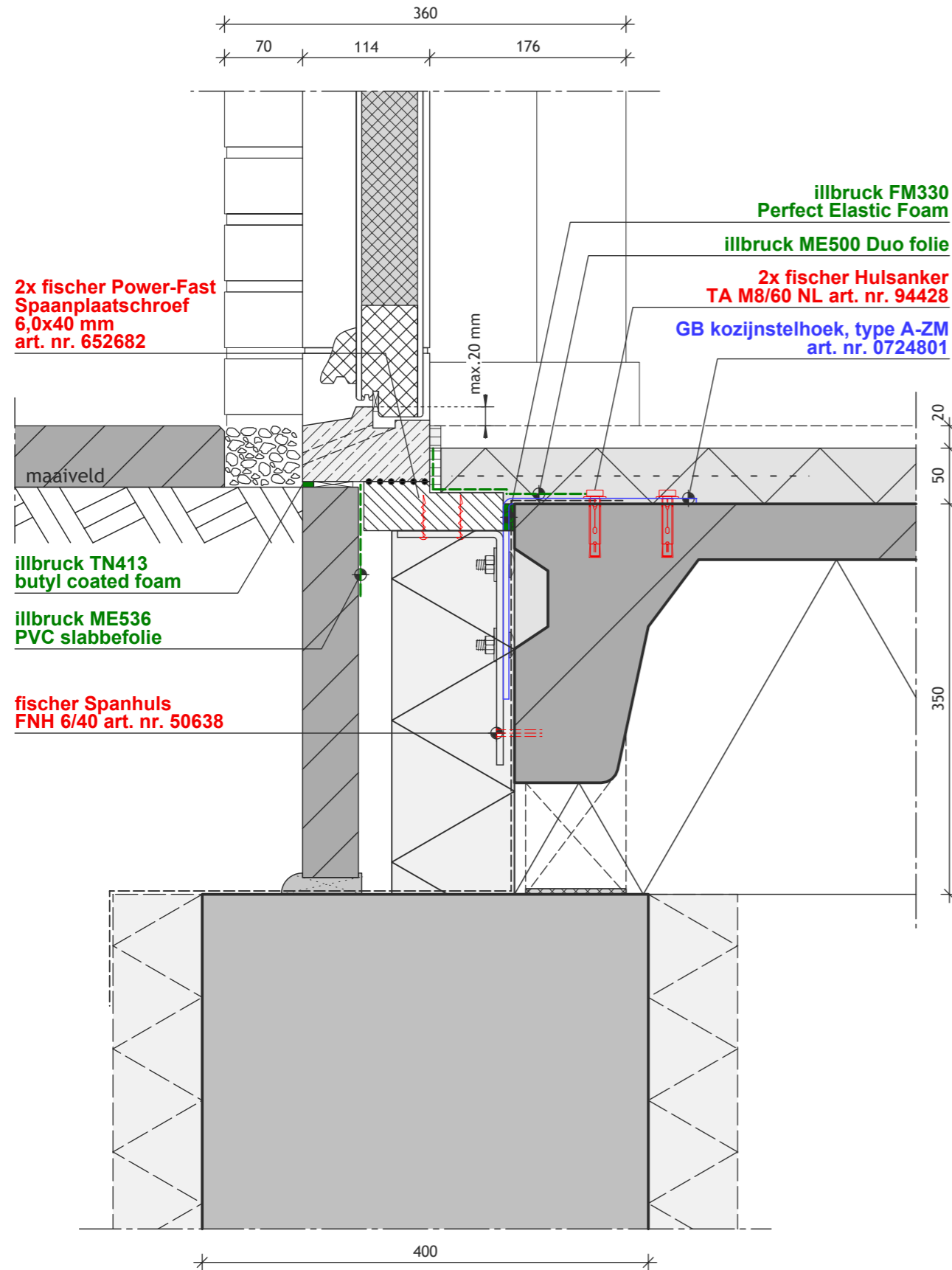

DKVDC - BOUWDETAIL 006

TREMCO ILLBRUCK

| Product [code + naam] | c-waarde [dm ³ /s.m] | λ waarde [W/m.K] | μ-waarde [m] | elasticiteit % | dikte [mm] | breedte [mm] | certificering [Instituut (raportnr.)] |
|----------------------------|---------------------------------|------------------|--------------|----------------|--------------|--------------|---------------------------------------|
| FM330 Perfect Elastic Foam | 0,0016 | 0,036 | - | 35 | - | - | SKG [03-245] |
| ME500 Duo folie | 0,0001 | - | 600 - 40.000 | - | 0,5 | 70 tot 300 | - |
| ME536 PVC slabbefolie | - | - | 5.000 | - | 0,4 | 300 tot 800 | - |
| TN413 Butyl coated foam | 0,0001 | - | 100.000 | 25 | 4,8 tot 12,7 | - | - |

GEBR. BODEGRAVEN

| Product | Art. nr. | Materiaal | Afmeting | Opmerking |
|--------------------------|----------|----------------|----------------------|-----------|
| Kozijnstelhoek type A-ZM | 0724801 | Zink Magnesium | 95x210/175 60x6/60x5 | |

FISCHER BENELUX

| Product | Art. nr. | Ondergrond | Boordiameter [mm] | Boorgatdiepte bij doorsteekmontage [mm] | Nuttige Lengte [mm] | Opname |
|-------------------------------------|----------|---------------------|-------------------|---|---------------------|--------|
| Hulsanker TA M8/60 NL | 94428 | Beton (horizontaal) | 12 | - | 0 - 15 | SW 13 |
| Spanhuls FNH 6/40 | 50638 | Beton / kanaalplaat | 6 | 50 | 10 | - |
| Power-Fast spaanplaatschroef 6,0x40 | 652682 | Hout | N.v.t. | N.v.t. | N.v.t. | PZ3 |